

MONTAGEANLEITUNG

Arbeits- und Werk Tisch

MONTAGEANLEITUNG

Arbeits- und Werkstisch

Working table
Tables de travail

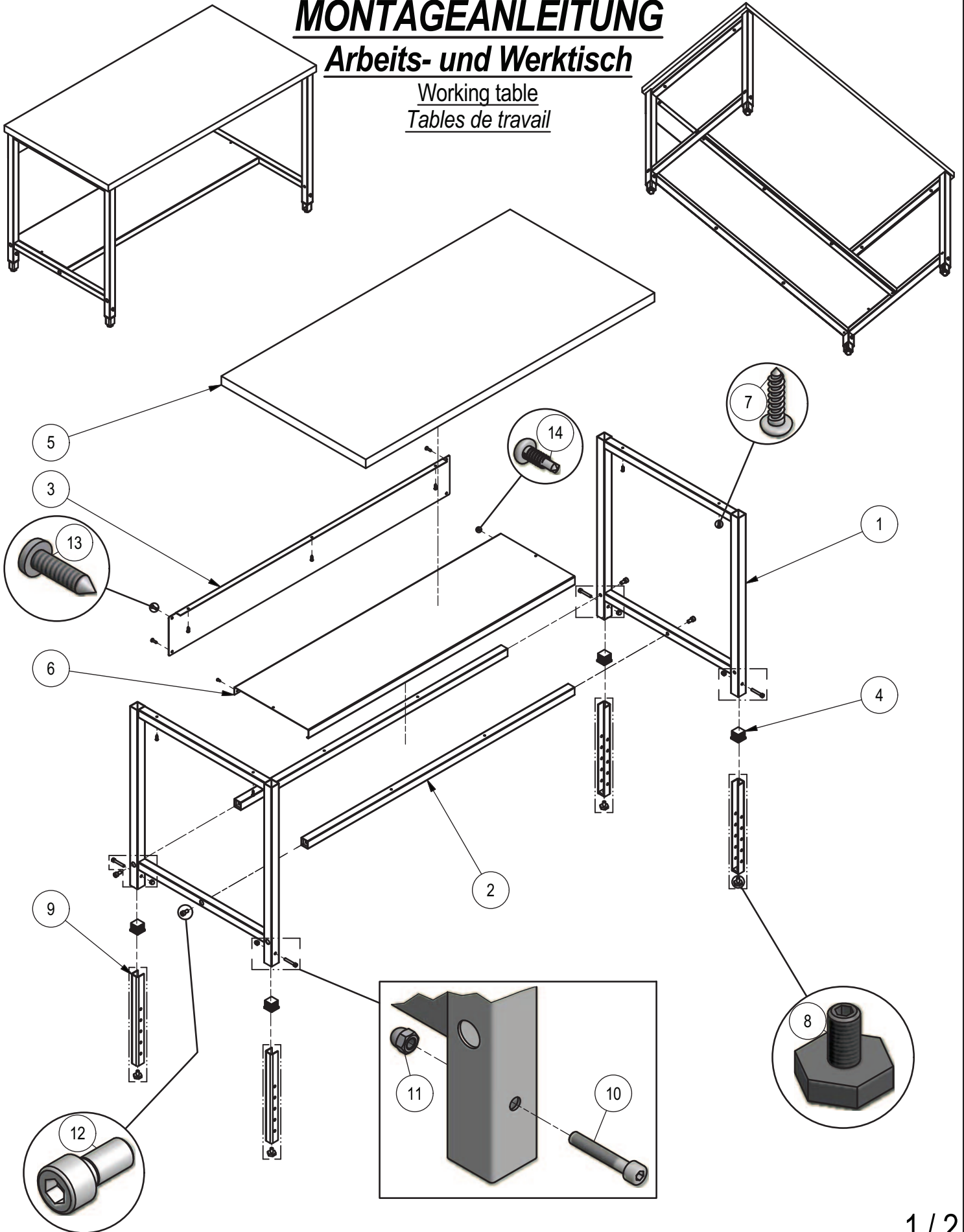

= Höhenverstellung um 200mm / Adjustable height for 200mm / Réglage de la hauteur de 200mm

MONTAGEANLEITUNG

Arbeits- und Werk Tisch

Working table
Tables de travail

Zubehör:

Accessories:

Accessoires:

① 2x

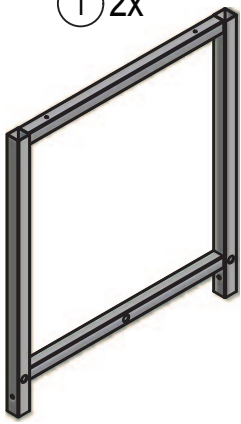

② 2x



③ 1x

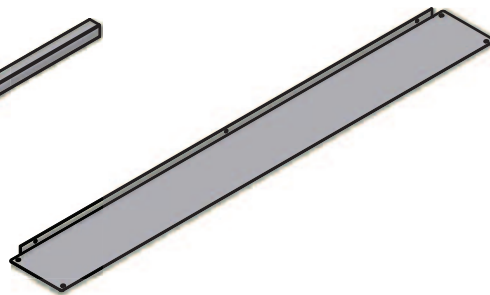

④ 4x 40x40/M22

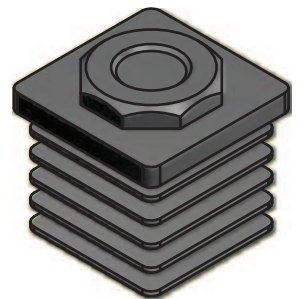

⑤ 1x

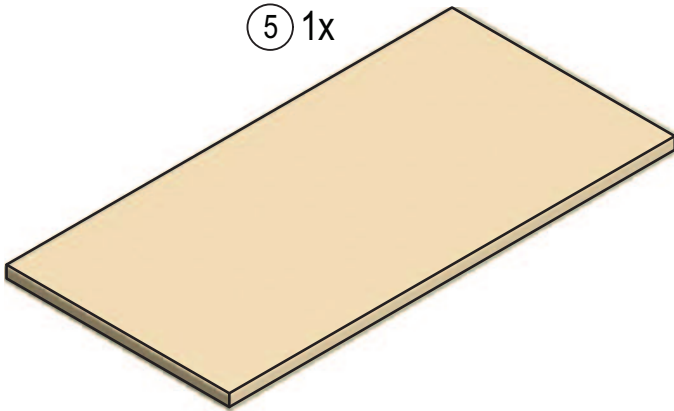

⑥ 1x

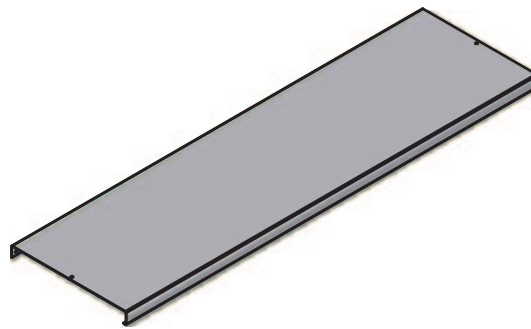

⑦ 7x Ø5x20



4x M10x25

⑧



⑨ 4x

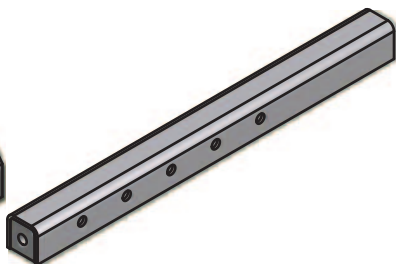

⑩ 4x M8x50



4x M8

⑪



4x M10x20

⑫



4x Ø6,3x25

⑬



2x Ø4,2x13

⑭



2 / 2

□ = Höhenverstellung um 200mm / Adjustable height for 200mm / Réglage de la hauteur de 200mm